

*Demo Mode*  
**SET-UP**

---





# Table of CONTENTS

## DEMO SETTINGS – YOUR ON-SITE SALES SUPPORT.

The right appliance presentation is the main element in the customer’s decision making. Live product demonstrations are a highly effective way to explain product benefits. To support live product presentations, many Thermador appliances feature a demo mode that allows customers to familiarize themselves with the functionality of our products without the aid of a salesperson.

### LIVE DISPLAYS

HOME CONNECT NETWORK REQUIREMENTS .....4

### DEMO SETTINGS

DISHWASHERS ..... 6

COOKTOPS ..... 8

MICRODRAWERS® ..... 10

OVENS | SPEED OVENS | MICROWAVES..... 11

COFFEE MACHINE ..... 13

REFRIGERATORS ..... 15

HOME CONNECT APP ..... 23

### INSTALLATION GUIDELINES – POWERING THERMADOR OVENS ON 120V

CONVENTIONAL OVENS..... 25

STEAM SINGLE OVENS..... 27

STEAM DOUBLE OVENS ..... 28





# HOME CONNECT™ NETWORK REQUIREMENTS FOR NON-RESIDENTIAL SETTINGS

## WELCOME TO HOME CONNECT

Home Connect is designed to work with Wi-Fi enabled BSH Home Appliances and is compatible with common router setups found in residential homes. For a non-residential setting, please ensure that the Home Connect Wi-Fi requirements are met and the directions of the app are followed along with the printed Home Connect installation guide that is included with the appliance.

## WI-FI REQUIREMENT FOR A SUCCESSFUL CONNECTION

Minimum connection requirements:

- **Encrypted Wi-Fi network:** Home Connect will not work with open networks. It requires security level WPA2 or at least WPA.
- **No browser registrations:** Home Connect does not work with Wi-Fi networks that require browser registration (i.e. where the username and password must be entered via the web browser).
- **Dual Band Support:** Most Home Connect appliances support 2.4 GHz and 5 GHz band. Please check to determine if your appliance only supports 2.4 GHz.: Thermador coffee: TCM24TS, TCM24PS
- **Compatible network modes:** IEEE 802.11 b, g and n. Please ensure that your router is set up accordingly.
- **Turn off the “MAC Filter”** on the router to prevent MAC addresses for your home appliances and communication-enabled appliances from being saved.
- **The use of proxies is not recommended.**
- **Ports 443, 8080 and 123 must be open.**
- **Enable multicast-routing option:** This option must be enabled on the router in order to establish a connection to Home Connect appliances. *(continue on next page)*



# HOME CONNECT™ NETWORK REQUIREMENTS FOR NON-RESIDENTIAL SETTINGS

## HINTS TO AVOID COMMON ERRORS

- **Ensure your smartphone/tablet and appliance** are connected to the same Wi-Fi network
- **Your appliance** is in range of the Wi-Fi network
- **You may experience connectivity issues** when there is too much WiFi interference
- **You should have a stable Wi-Fi network** with a strong signal and access to the Internet.
- **Follow Home Connect App Directions:** Follow the directions on the Home Connect app along with the printed Home Connect installation guide that is provided with your appliance. The installation guide can also be found on the company website’s product page.

Requirements and further support can be found here:

<http://www.home-connect.com/us/en/help-support/set-up>



If you have any questions, just visit us at [www.home-connect.com](http://www.home-connect.com) or contact Thermador at **1-800-735-4328** | [www.thermador.com](http://www.thermador.com)



# Start Dishwasher

## DEMO MODE



**STEP 2:** Once in program selection mode, turn off the unit

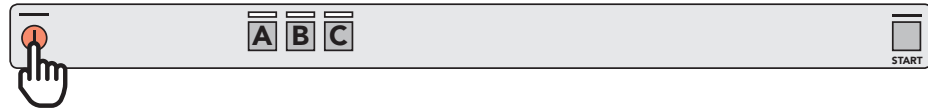

**STEP 3:** Press and hold down buttons "B" + "C"

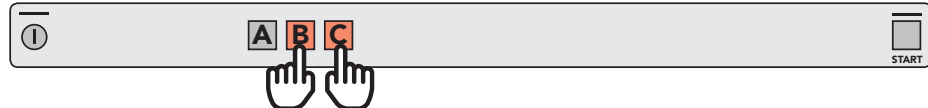

**STEP 4:** Then press the "on/off" button

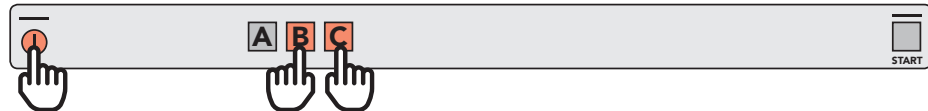

**STEP 5:** Release buttons when "P0" is displayed



**STEP 6:** Press button "B" until "P9" appears. This will place it in showroom mode

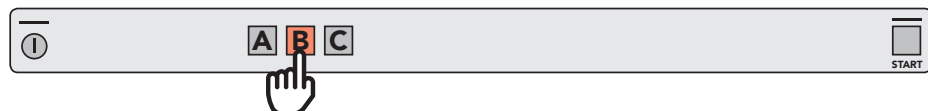

# To Exit Dishwasher

## DEMO MODE



**STEP 1:** Start a cycle



**STEP 2:** Cancel it by holding the Start button for 3 seconds

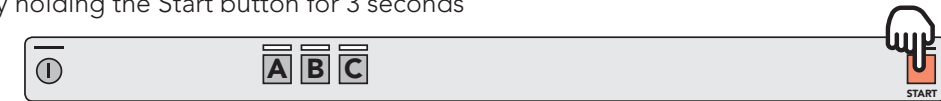

**STEP 3:** Press and hold down buttons "B" + "C"

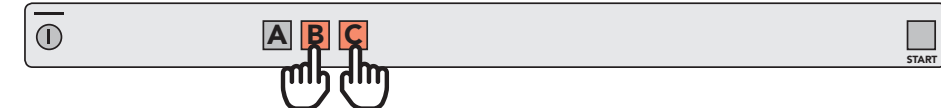

**STEP 4:** Once the "THERMADOR" logo appear, demo mode has been deactivated



### DEMO MODE INSTRUCTIONS APPLY TO FOLLOWING DISHWASHER MODELS:

<b>Emerald Dishwashers</b>	DWHD650WFM	DWHD650WFP	DWHD650WPR
<b>Topaz Dishwashers</b>	DWHD660WFM	DWHD660WFP	DWHD660WPR
<b>Sapphire Dishwashers</b>	DWHD770WFM	DWHD770WFP	DWHD770WPR
<b>Entertainer's Dishwashers</b>	DWHD771WFM	DWHD771WFP	DWHD771WPR
<b>Star Sapphire Dishwashers</b>	DWHD870WFM	DWHD870WFP	DWHD870WPR

# Liberty™ Induction Cooktop\*

## DEMO MODE

### START DEMO MODE:

Within the first 3 minutes after turning on main power supply, follow the steps below:

1. Press the **On/Off** button to turn the cooktop on.
2. Within 10 seconds, touch the **Kitchen Timer key** for about 4 seconds.
3. Touching the **Kitchen Timer key** again takes you to the basic settings. "c1" lights up in the timer display and "0" lights up in the displays.

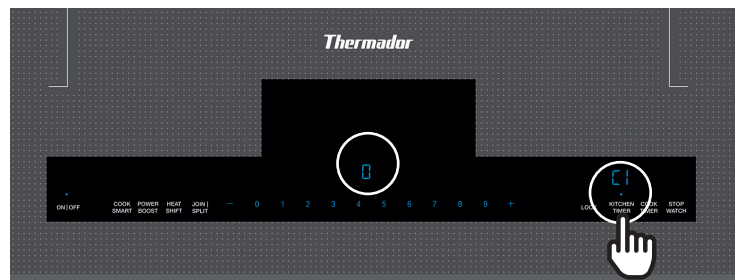

4. Touch the **Kitchen Timer key** repeatedly until "C8" lights up.

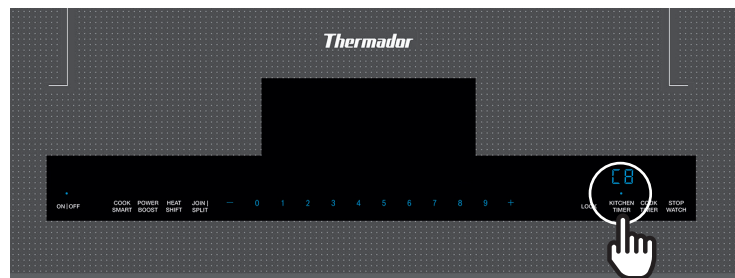

5. Set "1" as value with number keys. The cooking zones are not heated anymore.
6. Touch the **Kitchen Timer key** again for at least 4 seconds. The settings have been stored.
7. Now the demo mode is active and "dE" appears in the display.

### TO EXIT DEMO MODE:

Within the first 3 minutes after turning on the major supply, repeat above steps and return the value in "c8" to "1".

### DEMO MODE INSTRUCTIONS APPLY TO FOLLOWING LIBERTY INDUCTION COOKTOP MODELS:

CIT367TG	CIT367TGS
CIT367TM	CIT367TMS

# Masterpiece® Freedom® Induction Cooktop

## DEMO MODE

### START DEMO MODE:

The  symbol will appear during the first seconds after switching on the cooktop for the first time. After connecting to the power supply. Go to basic settings menu and activate during the first 3 minutes. Afterwards the symbol is hidden. The appliance does not heat up.

### DEACTIVATING DEMO MODE:

Disconnect the appliance from the power supply and then wait for a few seconds before reconnecting it. Then deactivate demo mode in the basic settings menu within the next 3 minutes.

### DEMO MODE INSTRUCTIONS APPLY TO FOLLOWING MASTERPIECE FREEDOM COOKTOP MODELS:

CIT30XWBB	CIT36XWBB	CIT36XWB
-----------	-----------	----------

# MicroDrawers® DEMO MODE

## TO START DEMO MODE:

1. Touch **Settings** pad five times. The display shows:



2. Hold **Start (+1 min)** pad for 3 seconds.

The display shows



## TO EXIT DEMO MODE:

1. Touch **Settings** pad five times. The display shows:



2. Touch **Start (+1 min)** pad.

The display shows



## NOTE:

- MicroDrawer® microwave oven doesn't heat in Demo Mode.
- Display counts down quickly.

## DEMO MODE INSTRUCTIONS APPLY TO FOLLOWING MICRODRAWER® MODELS:

MD24WS

MD30WS

# Masterpiece® Oven and Speed Oven DEMO MODE

1. Turn oven **"ON"**



2. Press **MENU** button

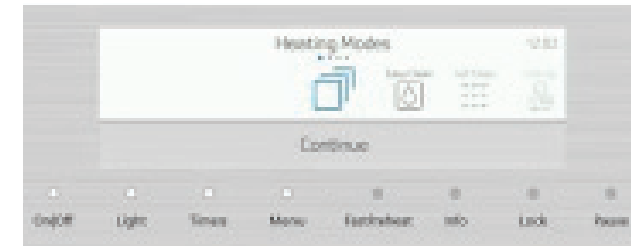

3. Press settings on touch screen and continue



4. Scroll through settings (left to right)



5. Turn Demo Mode from **"OFF"** to **"ON"**



6. Save Settings

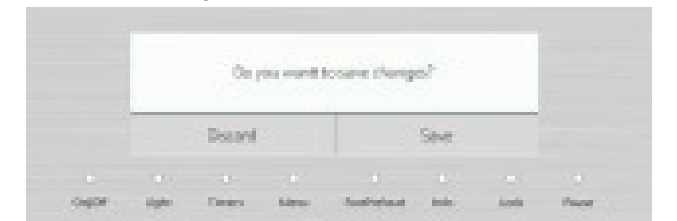

## DEMO MODE INSTRUCTIONS APPLY TO FOLLOWING MASTERPIECE® OVEN AND MICROWAVE MODELS:

MEDS301WS			
MEDS302WS			
MC30WS			
ME301WS	MED301WS	MED301LWS	MED301RWS
ME302WS	MED302WS	MED302LWS	MED302RWS
MEM301WS	MEDMC301WS	MEDMCW31WS	



# Professional Oven, Speed Oven, Microwave, and Masterpiece® Microwave

## DEMO MODE

1. Press "SETTINGS"



3. Turn Demo Mode from "OFF" to "ON"



4. Save settings



2. Scroll through settings (left to right)

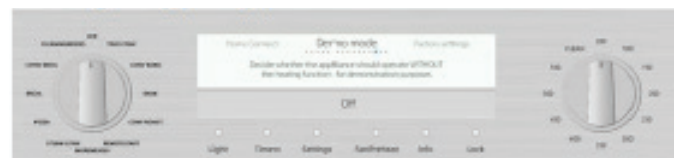

**DEMO MODE INSTRUCTIONS APPLY TO FOLLOWING PRO OVEN, SPEED OVEN, MICROWAVE,  
AND MASTERPIECE® MICROWAVE MODELS:**

PODS302W			
PODS301W			
MC30WP			
*MB30WP	*MB30WS		
PO301W	POD301W	POD301LW	POD301RW
PO302W	POD302W	POD302LW	POD302RW
POM301W	PODMC301W	PODMCW31W	

\* Images are not shown.

# Ranges with UI

## DEMO MODE

1. Turn power "OFF" and "ON" (main) for range – Demo Mode is only available in the UI for 5 minutes after the power is turned ON.



2. Use arrow keys on UI to scroll through the settings until Demo Mode Off option appears on the screen (right UI on double ovens).



3. Use the right hand arrow keys to change Demo Mode from OFF to the ON position



4. Press enter button to save settings - Video icon now appears in the UI to indicate Demo Mode is ON. To turn Demo Mode Off follow steps 1 - 4.



**DEMO MODE INSTRUCTIONS APPLY TO THE FOLLOWING RANGE MODELS:**

PRG364WDG	PRD484WCGU	PRD48WISGU	PRD48WDSGC	PRG364WLH	PRD486WDHU
PRG364WLG	PRD486WDGU	PRD606WCG	PRD364WLGC	PRG366WH	PRD486WLHU
PRG366WG	PRD486WLGU	PRD606WEG	PRD48WLSGC	PRG486WDH	PRD364WDHC
PRG486WDG	PRD48WDSGU	PRD606WCSG	PRD48WCSGC	PRG486WLH	PRD366WHC
PRG486WLG	PRD48WCSGU	PRD606WESG	PRD364WIGC	PRD364WDHU	PRD486WDHC
PRD364WDGU	PRD48WLSGU	PRD364WDGC	PRD486WIGC	PRD364WLHU	
PRD364WLGU	PRD364WIGU	PRD366WGC	PRD48WISGC	PRD366WHU	
PRD366WGU	PPRD486WIGU	PRD486WDGC	PRG364WDH	PRD484WCHU	

# Fully Automatic Coffee Machine

## DEMO MODE

### START DEMO MODE:

1. Restart the coffee machine by turning it off, then on again from the main switch located next to the accessory drawer.
2. Press settings
3. Press right arrow key (>) until "Demo Mode" appears on screen

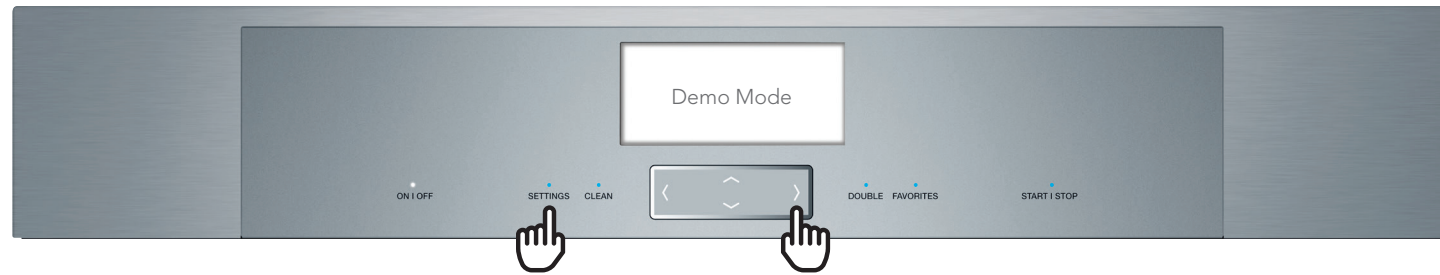

4. Use the down arrow key (v) to select "On"
5. Press settings again, and select "Yes" to save new settings

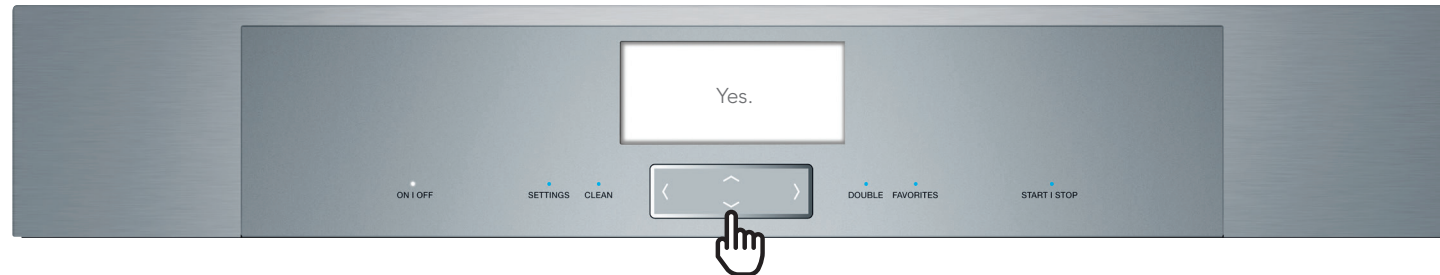

### DEMO MODE INSTRUCTIONS APPLY TO FOLLOWING COFFEE MACHINE MODEL:

TCM24RS

TCM24TS

TCM24PS

# Freedom® Refrigeration 800 Series

## Fresh Food Columns

## DEMO MODE

### ACTIVATION:

1. Press **Power (1.)** to turn unit off
2. Press **Power (1.)** to turn unit on
3. Within 30 seconds after turning on the unit, simultaneously press **Setup (2.)** and **Super (3.)** until the word **DEMO (4.)** is displayed

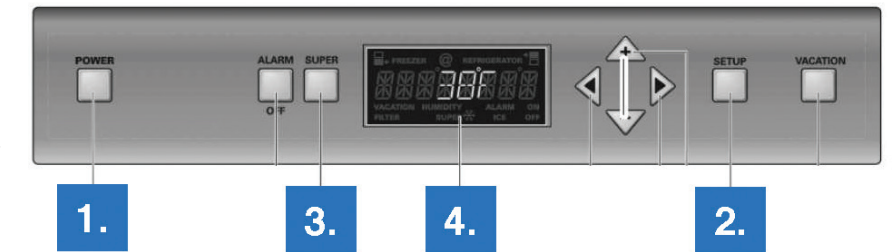

### DEMO MODE:

1. Display functions can be demonstrated
2. Ventilator and interior light are active
3. All other components are not active

### DEACTIVATION:

Press **Power (1.)** to turn unit off

### DEMO MODE INSTRUCTIONS APPLY TO FOLLOWING FREEDOM® REFRIGERATION FRESH FOOD COLUMN MODELS:

T24IR800SP

T30IR800SP



# Freedom® Refrigeration 800 Series Freezer Columns

## DEMO MODE

### ACTIVATION:

1. Press **Power (1.)** to turn unit off
2. Press **Power (1.)** to turn unit on
3. Within 30 seconds after turning on the unit, simultaneously press **Setup (2.)** and **Super (3.)** until the word **DEMO (4.)** is displayed

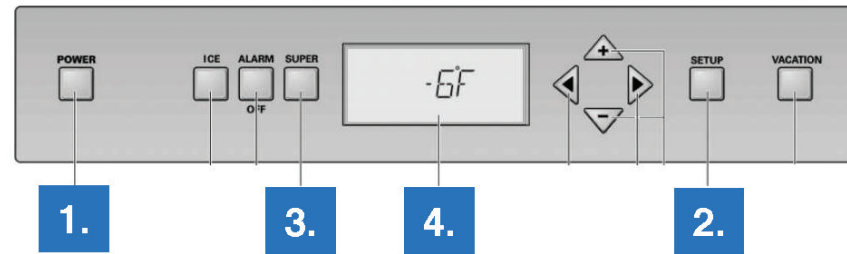

### DEMO MODE:

1. Display functions can be demonstrated
2. Ventilator and interior light are active
3. All other components are not active

### DEACTIVATION:

Press **Power (1.)** to turn unit off

### DEMO MODE INSTRUCTIONS APPLY TO FOLLOWING FREEDOM® REFRIGERATION FREEZER COLUMN MODELS:

<b>Freezer</b>	T18IF800SP	T24IF800SP	T30IF800SP
<b>Freezer with external Ice and Water</b>	T18ID800LP / T18ID800RP	T24ID800LP / T24ID800RP	

# Freedom® Refrigeration 800 Series Wine Preservation

## DEMO MODE

### ACTIVATION:

1. Press **Power (1.)** to turn unit off
2. Press **Power (1.)** to turn unit on
3. Within 30 seconds after turning on the unit, simultaneously press **Setup (2.)** and **+ (3.)** until the word **DEMO (4.)** is displayed

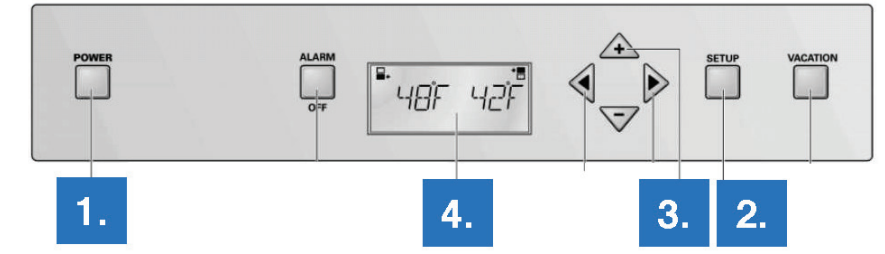

### DEMO MODE:

1. Display functions can be demonstrated
2. Ventilator and interior light are active
3. All other components are not active

### DEACTIVATION:

Press **Power (1.)** to turn unit off

### DEMO MODE INSTRUCTIONS APPLY TO FOLLOWING FREEDOM® REFRIGERATION WINE PRESERVATION MODELS:

T18IW800SP | T24IW800SP

# Freedom® Refrigeration 800 Series Bottom Freezer and French Door DEMO MODE

## ACTIVATION:

1. Press **Power (1.)** to turn unit off
2. Press **Power (1.)** to turn unit on
3. Within 30 seconds after turning on the unit, simultaneously press **Setup (2.)** and **Cool (3.)** until the word **DEMO (4.)** is displayed

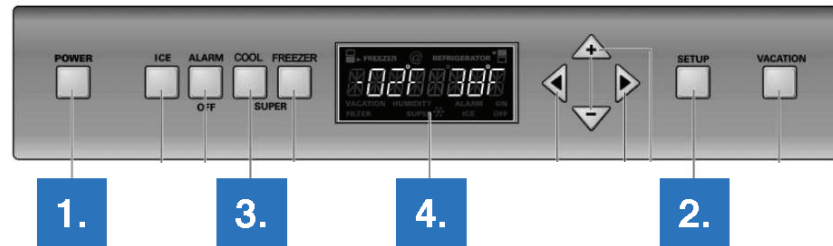

## DEMO MODE:

1. Display functions can be demonstrated
2. Ventilator and interior light are active
3. All other components are not active

## DEACTIVATION:

Press **Power (1.)** to turn unit off

## DEMO MODE INSTRUCTIONS APPLY TO FOLLOWING FREEDOM® REFRIGERATION BOTTOM FREEZER AND FRENCH DOOR MODELS:

Bottom Freezer	T30IB800SP	T30BB810SS	T30BB820SS
	T36IB800SP	T36BB810SS	T36BB820SS
French Door	T36IT800NP	T36BT810NS	T36BT820NS

# Freedom® Refrigeration 900 Series DEMO MODE

FRESH FOOD COLUMNS | FREEZERS | WINE PRESERVATION | BOTTOM FREEZER | FRENCH DOOR

## ACTIVATION:

1. Go to **Settings** on Opening Screen
2. Hit arrow to scroll thru settings until you come to **Demo Mode**.

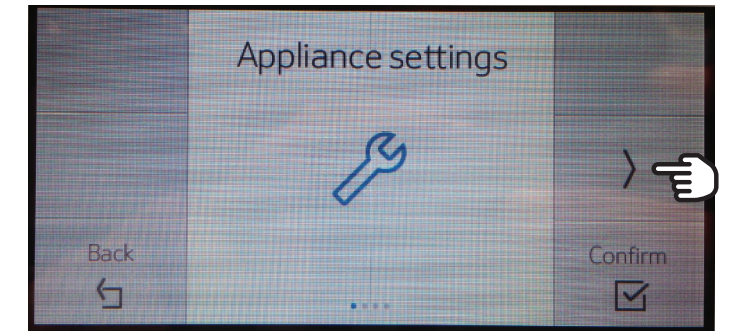

3. Once you are on the **Demo mode** screen click on **Edit**

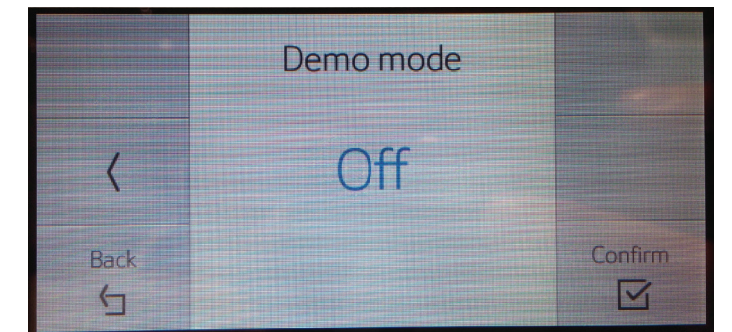
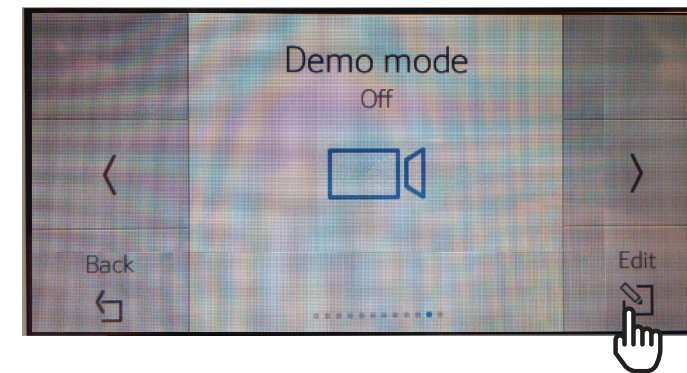

5. Once you have selected **On** or **Off** click on **Confirm** (continue on next page)

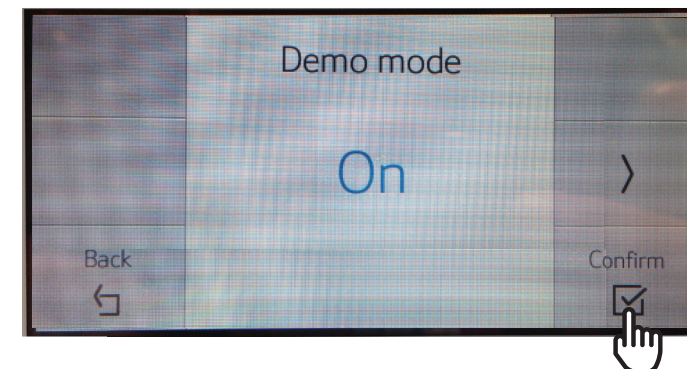

# Freedom® Refrigeration 900 Series

## DEMO MODE

FRESH FOOD COLUMNS | FREEZERS | WINE PRESERVATION | BOTTOM FREEZER | FRENCH DOOR

### DEMO MODE INSTRUCTIONS APPLY TO FOLLOWING FREEDOM® REFRIGERATION 900 SERIES MODELS:

18" BI Freezer, IWD, LH, ENERGY STAR®	T18ID900LP
18" BI Freezer, IWD, RH, ENERGY STAR®	T18ID900RP
18" BI Freezer, IM, ENERGY STAR®	T18IF900SP
18" BI Wine Preservation	T18IW900SP
24" BI Freezer, IWD, LH, ENERGY STAR®	T24ID900LP
24" BI Freezer, IWD, RH, ENERGY STAR®	T24ID900RP
24" BI Freezer, IM, ENERGY STAR®	T24IF900SP
24" BI Fresh Food, ENERGY STAR®	T24IR900SP
24" BI Wine Preservation	T24IW900SP
23" BI Fresh Food, ENERGY STAR®	T23IR900SP
30" BI 2-Door BM, Master, Assembled SS, ENERGY STAR®	T30BB910SS
30" BI 2-Door BM, Pro, Assembled SS, ENERGY STAR®	T30BB920SS
30" BI 2-Door BM, ENERGY STAR®	T30IB900SP
30" BI Freezer, IM, ENERGY STAR®	T30IF900SP
30" BI Fresh Food, ENERGY STAR®	T30IR900SP
36" BI 2-Door BM, Master, Assembled SS, ENERGY STAR®	T36BB910SS
36" BI 2-Door BM, Pro, Assembled SS, ENERGY STAR®	T36BB920SS
36" BI FBM, Master, Assembled SS, ENERGY STAR®	T36BT910NS
36" BI FBM, Pro, Assembled SS, ENERGY STAR®	T36BT920NS
36" BI 2-Door BM, ENERGY STAR®	T36IB900SP
36" BI Freezer, ENERGY STAR®	T36IF900SP
36" BI Fresh Food, ENERGY STAR®	T36IR900SP
36" BI FMB, ENERGY STAR®	T36IT900NP

# Freedom® Refrigeration

## Under Counter 800/900 Series

## DEMO MODE

GLASS DOOR WINE PRESERVATION | DOUBLE DRAWER REFRIGERATION |  
COMBO DRAWER REFRIGERATION | **FOR PRO, MASTERPIECE® AND CUSTOM**

### SHOWROOM/DEMO MODE:

1. During Showroom/Demo mode: **compressor, fans and ice maker should be turn off.**  
**Holding for 3 seconds LIGHT and COOLER on Wine Cellar or QUICK CHILL and BAR on rest of models** should activate Showroom/Demo mode, **"SHO"** will appear flashing on display for **5 seconds.** Holding again combination will disable showroom, **"SHF"** will appear on display flashing for 5 seconds.
2. Re-energize (unplug and plug) unit to resume in normal operation.
3. Demo mode should be save on non-volatile memory.  
On case of power failure it will turn on this mode.
4. On power up **"SHO"** will appear flashing on display for 5 seconds.  
During Showroom/Demo: **all alarms should be disengaged.** (continue on next page)

### DEMO MODE INSTRUCTIONS APPLY TO FOLLOWING FREEDOM® UNDER COUNTER 800 SERIES MODELS:

#### 800 SERIES

Glass Door Wine Reserve Pro Left Swing	T24UW820LS
Glass Door Wine Reserve Pro Right Swing	T24UW820RS
Glass Door Wine Reserve Masterpiece Left Swing	T24UW810LS
Glass Door Wine Reserve Masterpiece Right Swing	T24UW810RS
Glass Door Wine Reserve Custom Left Swing	T24UW800LP
Glass Door Wine Reserve Custom Right Swing	T24UW800RP
Double Drawer Refrigeration Pro Handle	T24UR820DS
Double Drawer Refrigeration Masterpiece Handle	T24UR810DS
Double Drawer Refrigeration Custom Panel	T24UR800DP



# Freedom® Refrigeration Under Counter 800/900 Series DEMO MODE

GLASS DOOR WINE PRESERVATION | DOUBLE DRAWER REFRIGERATION |  
COMBO DRAWER REFRIGERATION | **FOR PRO, MASTERPIECE® AND CUSTOM**

## DEMO MODE INSTRUCTIONS APPLY TO FOLLOWING FREEDOM® UNDER COUNTER 900 SERIES MODELS:

### 900 SERIES

Glass Door Refrigeration Custom Left Swing	T24UR900LP
Glass Door Wine Reserve Pro Right Swing	T24UR900RP
Glass Door Wine Reserve Masterpiece Left Swing	T24UR910LS
Glass Door Wine Reserve Masterpiece Right Swing	T24UR910RS
Glass Door Wine Reserve Custom Left Swing	T24UR920LS
Glass Door Wine Reserve Custom Right Swing	T24UR920RS
Glass Door Wine Reserve Left Swing	T24UW900LP
Glass Door Wine Reserve Right Swing	T24UW900RP
Glass Door Wine Reserve Left Swing	T24UR910LS
Glass Door Wine Reserve Right Swing	T24UR910RS
Glass Door Wine Reserve Left Swing	T24UW920LS
Glass Door Wine Reserve Right Swing	T24UW920RS
Double Drawer Refrigeration Custom Panel	T24UC900DP
Double Drawer Refrigeration Pro Handle	T24UC920DS
Double Drawer Refrigeration Masterpiece Handle	T24UC910DS
Double Drawer Refrigerator Custom Panel	T24UR900DP
Double Drawer Refrigerator Pro Handle	T24UR920DS
Double Drawer Refrigerator Masterpiece Handle	T24UR910DS

# Home Connect App DEMO MODE

1. Install and open the Home Connect (America) app. On the front page - press the button on the bottom. There is **no need to create an account.** (continue on next page)



Try demo

# Home Connect App DEMO MODE

## SALES SPECIAL:

- There is a “hidden” demo account for sales. If you **press and hold** the button **A. “Try demo”**, the **B. selection below** appears.

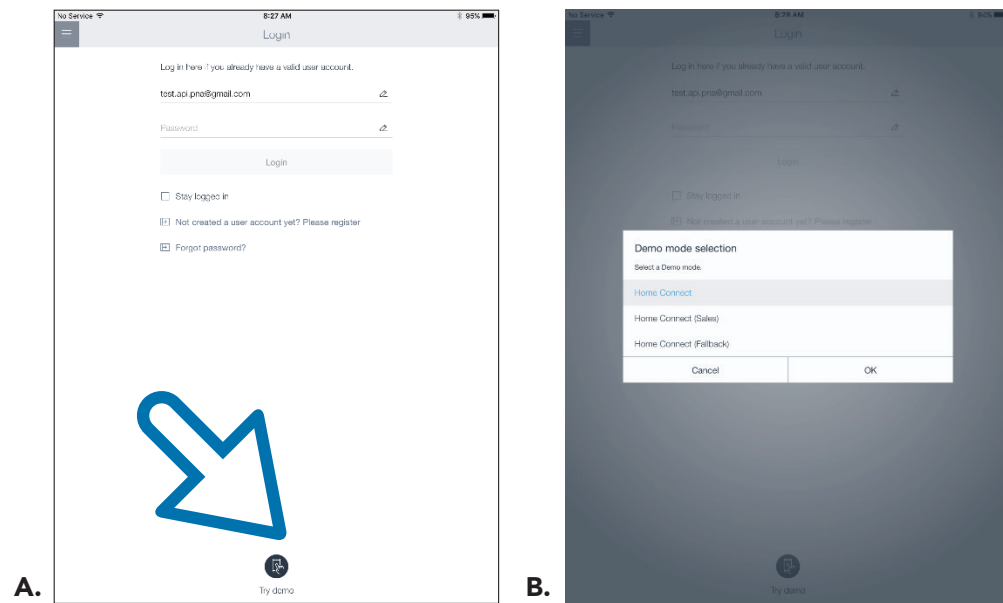

- Select **“Home Connect (Sales).”**  
In early 2018 you will be also able to select a Thermador demo mode there.

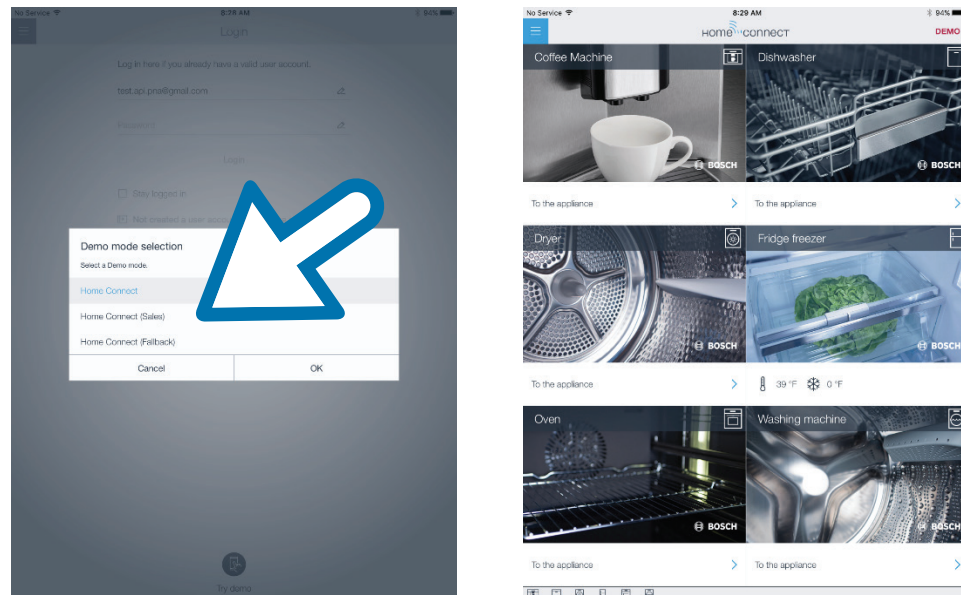

# Powering Thermador Ovens on 120v INSTALLATION GUIDELINES

Thermador Single, Double and Triple Ovens can be demonstrated using one 120v outlet. Thermador **Single Steam** and **Steam Double ovens** are new and unique, requiring special attention to wiring them on 120v for demonstration purposes. Please follow these instructions carefully to avoid issues.

User Interface (UI) Settings must be changed within the first two minutes of power-up. Select Settings, Demo Mode ON, Save settings, wait for the UI to reboot, and then unplug the unit – wait 10 seconds – and plug the unit back in.

Demo Mode is activated when a camera symbol is indicated on the UI:  The oven will function normally without engaging the elements.

Note all wire connections should be performed by a qualified technician or electrician, and be contained within a NEC approved junction box. *(continue on next page)*

## MASTERPIECE® AND PROFESSIONAL SINGLE/DOUBLE/TRIPLE/COMBO CONVENTIONAL OVEN MODELS:

ME301WS	PO302W
MED301WS	POD302W
MED301LWS	POD302LW
MED301RWS	POD302RW
PO301W	MEM301WS
POD301W	POM301W
POD301LW	MEDMC301WS
POD301RW	PODMC301W
ME302WS	MEDMCW31WS
MED302WS	PODMCW31W
MED302LWS	
MED302RWS	

# Powering Thermador Ovens on 120v

## INSTALLATION GUIDELINES

### CONVENTIONAL OVENS

Masterpiece and Pro Standard and Deluxe, with or without Warming Drawer, Single, Double, Triple or Combination Conventional ovens only (not Steam.)

Instruction: Tie the oven's Black and Red leads together with the power cord's Black wire. Tie White to White and Green to Green. (continue on next page)

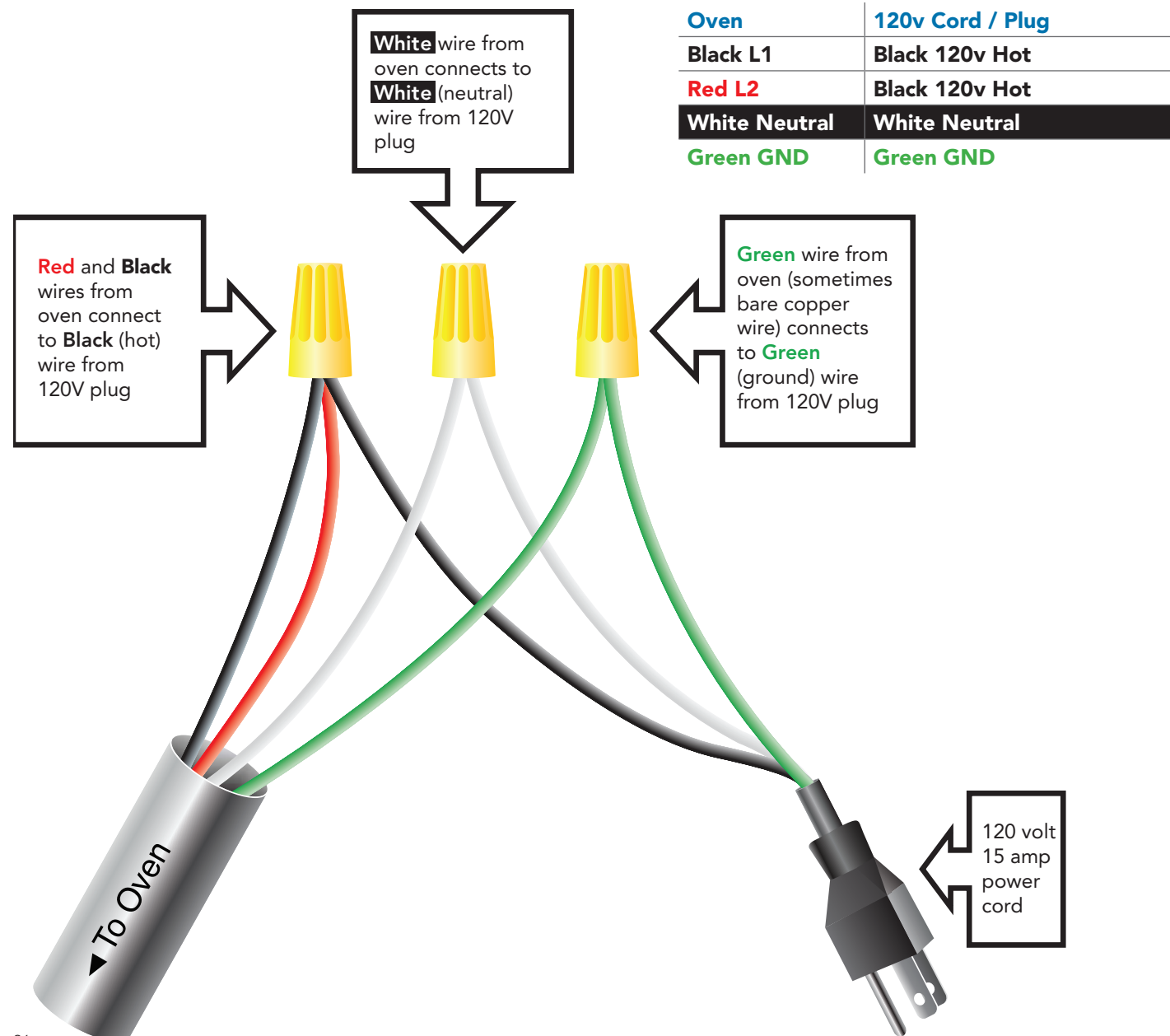

# Powering Thermador Ovens on 120v

## INSTALLATION GUIDELINES

### STEAM SINGLE OVEN

Masterpiece® and Pro Single Steam only.

Instruction: Tie the oven's Red lead to the power cord's White wire. Tie Black to Black and Green to Green. (continue on next page)

### MASTERPIECE® AND PROFESSIONAL STEAM SINGLE OVEN MODELS:

MEDS301WS | PODS301W

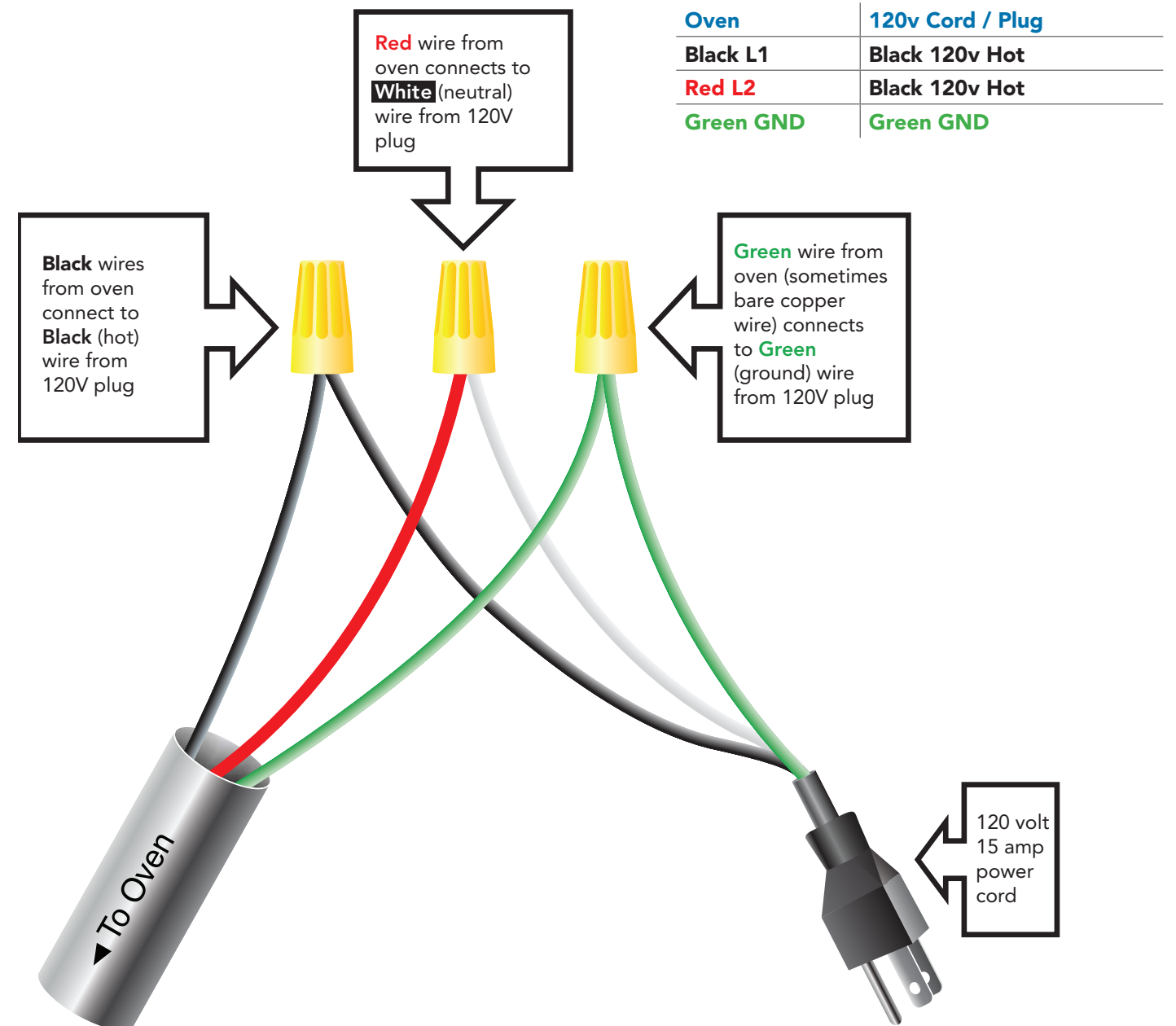



# Powering Thermador Ovens on 120v

## INSTALLATION GUIDELINES

### STEAM DOUBLE OVEN

Masterpiece® and Pro Steam Double only. This combination has a Steam Oven on top and a Conventional Oven on the bottom. Please note the Steam Double requires a unique wiring solution that applies to no other Thermador oven

Instruction: Tie the oven's Red and White leads together with the power cord's White Lead. Tie Black to Black and Green to Green.

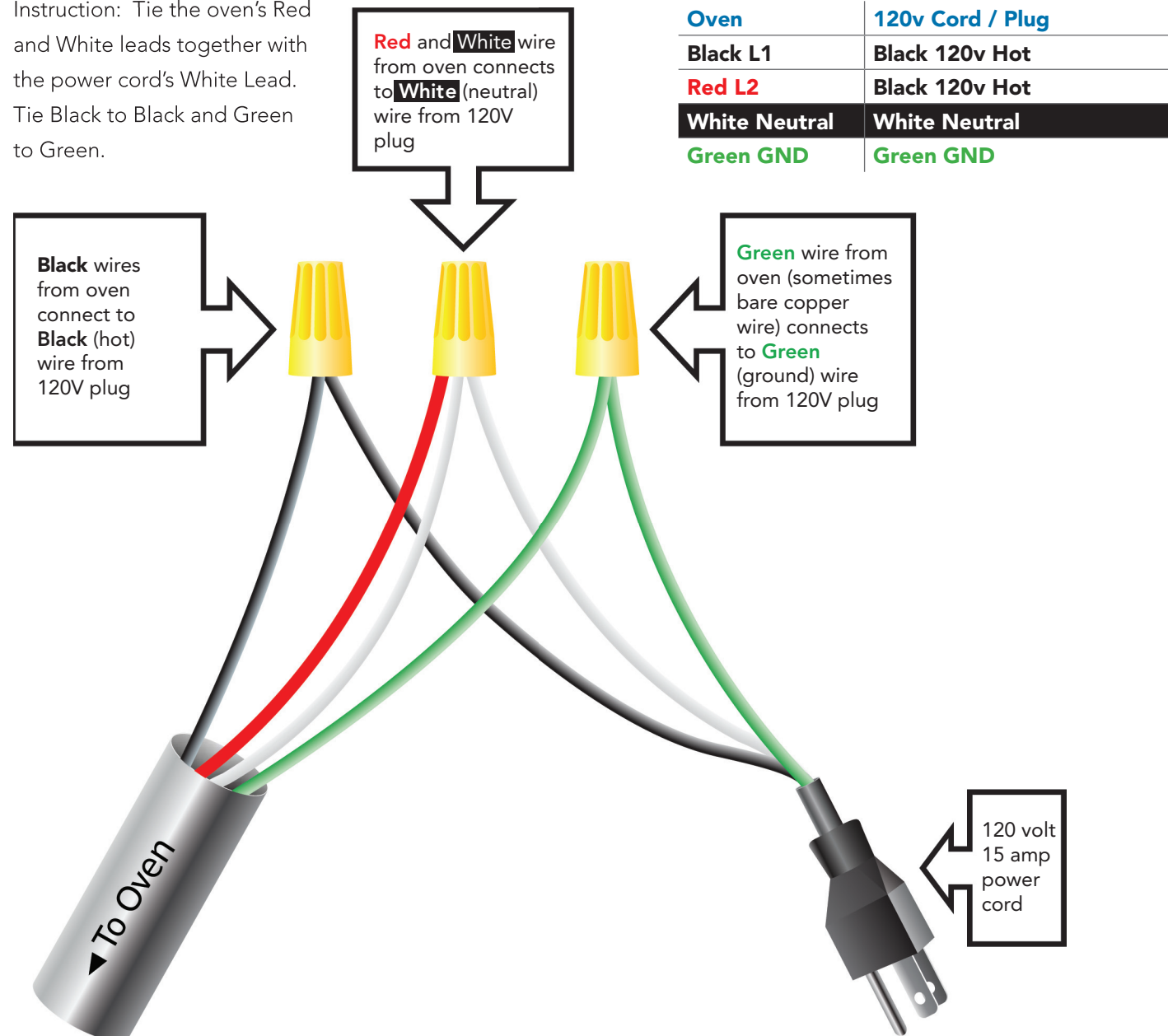

# Powering Thermador Ovens on 120v

## INSTALLATION GUIDELINES

### DUAL FUEL (NON-STEAM) RANGES

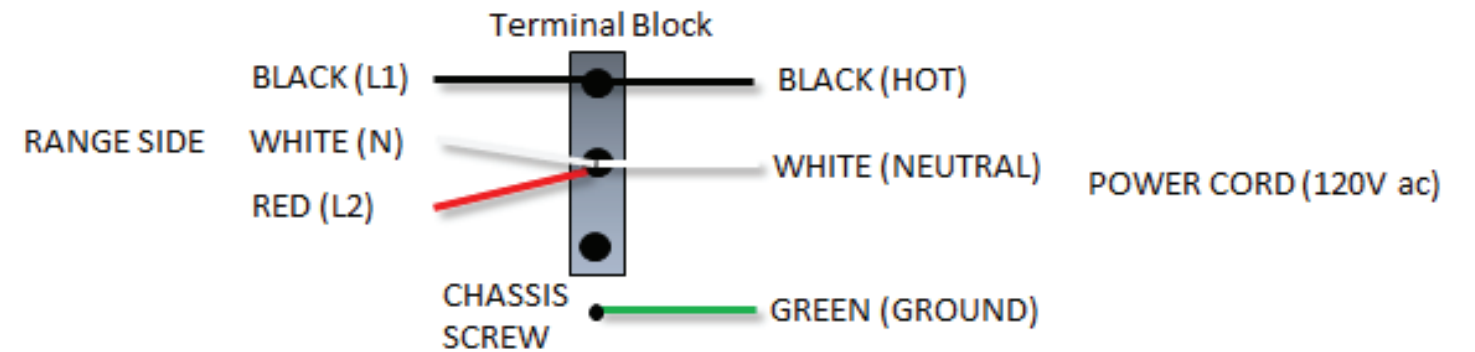

### STEAM RANGES

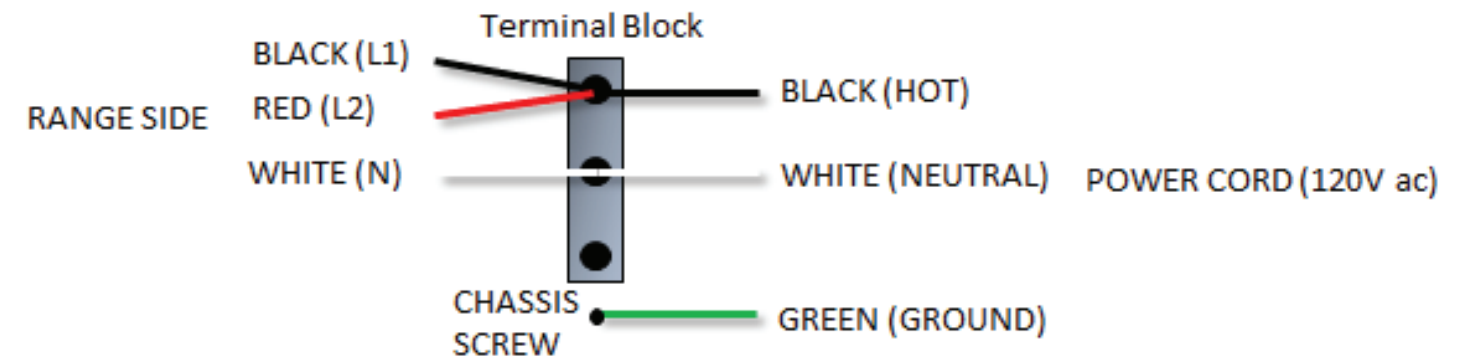



1901 MAIN STREET, SUITE 600 | IRVINE, CA 92614 | 1-800-735-4328 | [WWW.THERMADOR.COM](http://WWW.THERMADOR.COM)

©2018 BSH HOME APPLIANCES CORPORATION

18-THD-0753 5/19